



Cart Loaders Achieve Additional Labor Savings

Achieve greater labor savings in handling carts with automatic cart loaders and increase your overall distribution efficiency. Cannon cart loaders incorporate advanced design features for lasting performance and trouble free operation.

- Reduces the occurrence of repetitive motion injuries and limits your exposure to workers' compensation claims.
- Latest design will allow for future conversion from 120 to 80-gallon carts, or vice versa.
- Adaptable to single or dual infeed operation.
- Loads plastic gallon jugs with option for loading plastic or paper half-gallons.
- Self adjusting transition plates extend into the cart and allow for variation in wheel wear, providing smooth transfer of the container from the loader elevator to the cart shelves.

Optional line dividers split the flow of containers from a single filling line into a dual infeed conveyor that supplies the cart loader, yielding a 25% increase in operating speed.

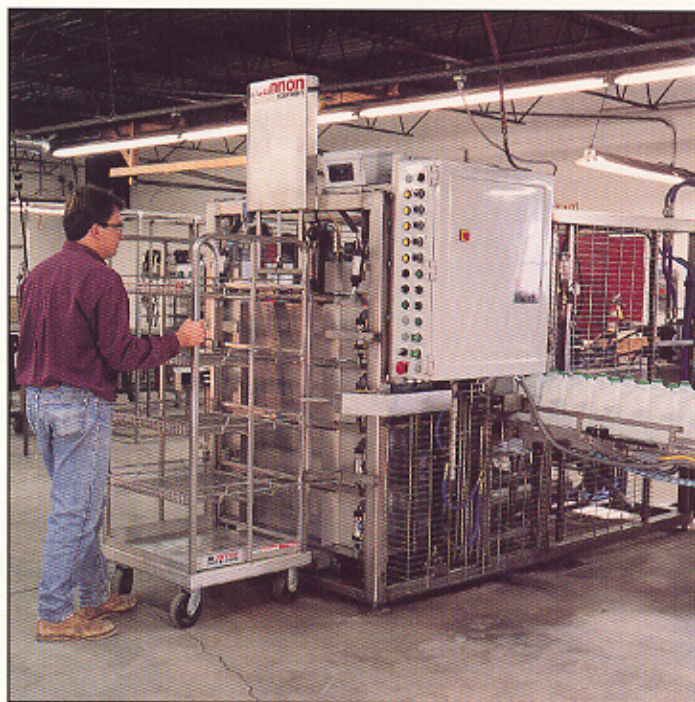
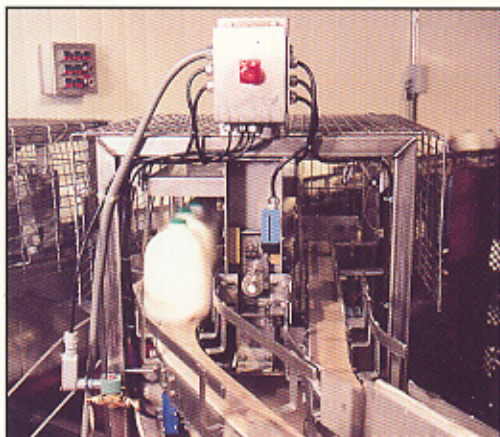

A three shelf elevator accumulates product for loading carts, allowing the operator up to 20 seconds to remove a loaded cart and replace it with an empty. This patented feature provides a steady flow of product inside the loader while carts are moved in and out of position.

cannon
EQUIPMENT

Additional Features and Benefits

- Programmable logic controllers provide ease of operation.
- Cart counter standard.
- Automatic pusher ejects loaded carts to provide nearly effortless removal by the loader operator.
- Stainless steel wire guards for easy cleaning and visual monitoring.
- Stainless steel construction for corrosion resistance and increased longevity.
- Non-metallic NEMA 4X electrical enclosure.

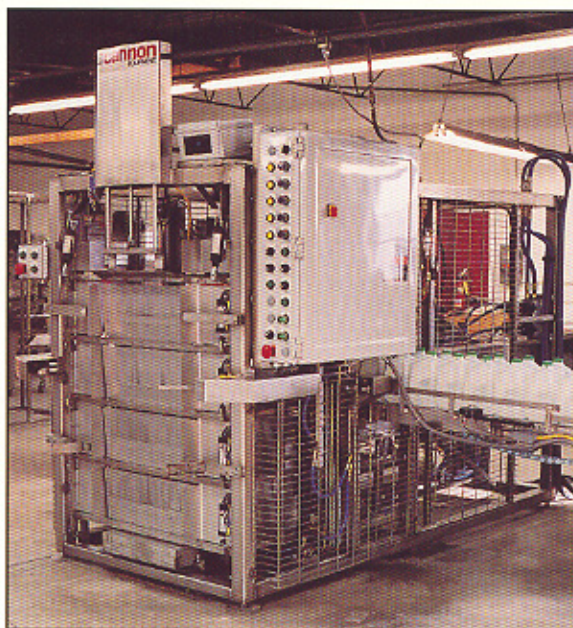

Optional Line Divider

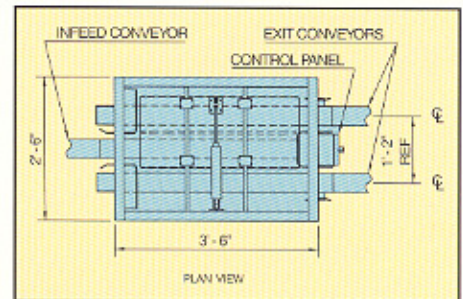

Construction: Stainless steel
Electrical Power: 2 Amps @ 1/60/120V.
Pneumatic: 0.5 SCFM @ 80 PSI.
Hydraulic: 5 GPM @ 800 PSI.

Our latest loader design features transition plates that are retracted as soon as a cart is removed from the loading station to prevent operator access while product continues to accumulate in the three shelf elevator.

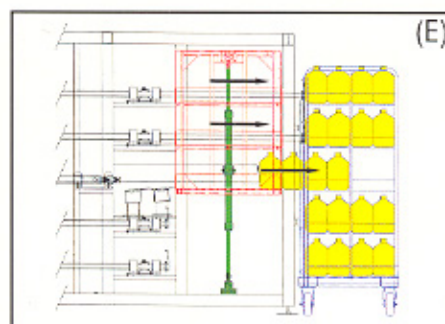
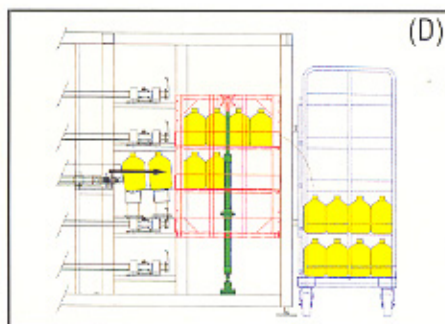
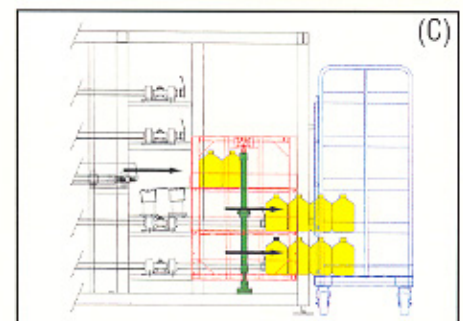
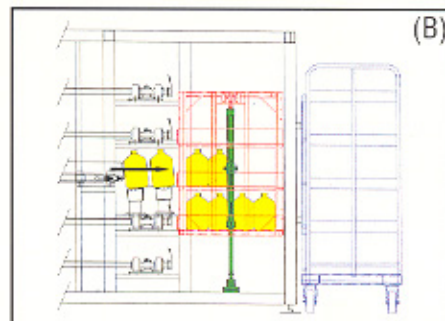
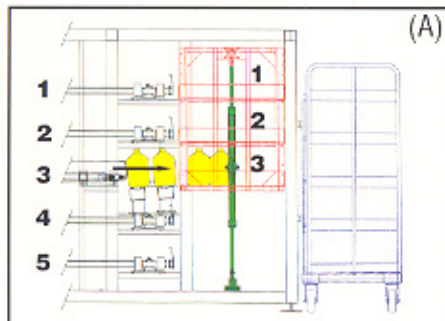

Loading Sequence

- Main pusher loads shelf #3.
- Elevator drops and shelf #2 is loaded.
- Elevator drops and shelf #1 is loaded while pushers 4 and 5 transfer containers to the lower two shelves on the cart.
- Elevator rises and shelf #2 is loaded.
- Elevator rises and shelf #3 is loaded while pushers 1 and 2 transfer containers to the upper two shelves on the cart. When shelf #3 is transferred to the center shelf, the cart is removed and the cycle repeats.

Specifications

Main Power Supply:
15 Amps @ 1/60/120V.

Hydraulic Requirements:
33 GPM @ 900 PSI.

Hydraulic power units available upon request.

Pneumatic: 1.3 SCFM @ 90 PSI.

For more information call:
1-800-533-2071

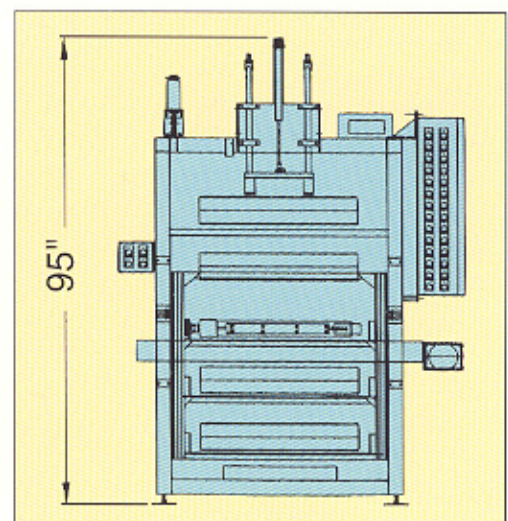
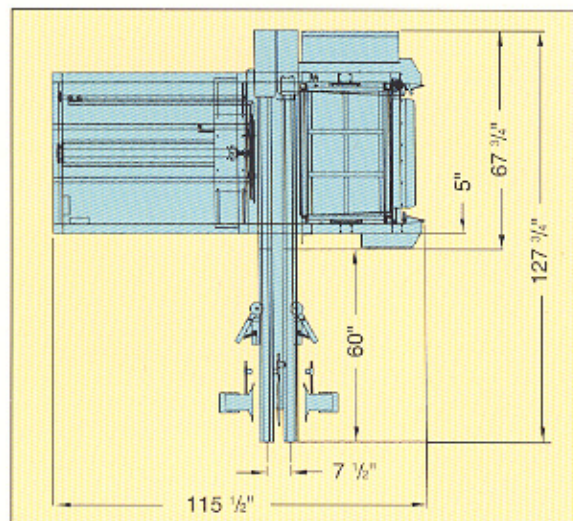

U.S. Patent No. 4,634,333



Corporate Headquarters
15100 Business Parkway
Rosemount, MN 55068

1001 Johnson Parkway
St. Paul, MN 55106

324 West Washington
Cannon Falls, MN 55009

950 Riverside Drive
Chattanooga, TN 37401

12822 Monarch Street
Garden Grove, CA 92841